

## Machete 30/40/60

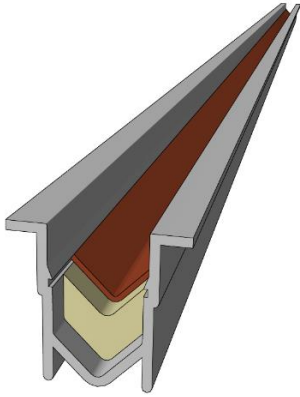

The Machete is a versatile, self-fill family of linear cutting charges designed for ease of use and reliability. The charges can be loaded with varied liners for use in differing conditions. The Machete is simple to assemble and includes a built-in standoff. The end caps incorporate an integral detonator mount to place the detonator in the correct location for optimum initiation and performance. The penetration performance with a standard copper liner is 30 - 60 mm in steel at the built-in standoff distance.

**Loading method:**

- i. Select the length of charge required, allowing a further 25 mm for run up distance from the detonator.
- ii. Slide the copper into the housing
- iii. Ensure the copper is seated correctly in the channel on both sides of the housing
- iv. Place the endcap on to one end
- v. Soften 15 – 20 g of the selected Plastic Explosive in your hands and place into void in the housing
- vi. Tamp down with the provided tool, until the explosive has moved into all voids
- vii. Repeat the filling until 15mm from the end of the length
- viii. The last section may be filled with a booster material or knot of Detonating cord to ensure prompt initiation
- ix. The end cap can then be placed onto the open end of the Machete and fixed into position

| Product    | Cut Depth (mm) | Liner (mm) | Loading (g/m) |
|------------|----------------|------------|---------------|
| Machete 30 | 30             | 1          | 460           |
| Machete 40 | 40             | 1.5        | 1200          |
| Machete 60 | 60             | 2          | 2225          |